

SW40 Series Data sheet

The SW40 aluminium-wood window blends the quality of the materials with the elegance of its design. The open-joint product is characterised by the full wood frame for wing and by the contrasting glazing bead that allows a good thermal insulation with a U_w value of $1,6 \text{ W/m}^2\text{K}$.

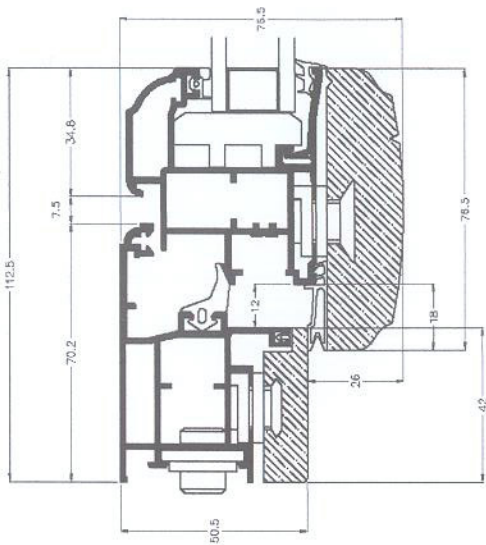

Technical characteristics:

System to open-joint
 Glass application: with contrasting glazing bead.
 Aluminium alloy: 6060 (UNI 3569).
 Wood types: oak, ash, cherry, maple
 Frame thickness 50.5 mm
 Wing thickness 74.5 mm

Thermal performance*:

one-wing window:

$U_w 1,6 \text{ W/m}^2\text{K}$



two-wings window:

$U_w 1,8 \text{ W/m}^2\text{K}$

Test:

Air (UNI EN 1026) 4
 Water (UNI EN 1027) 9A
 Wind (UNI EN 12211) C5
 Thermal (UNI EN 12567-1) $U_f 2,57 \text{ W/m}^2\text{K}$

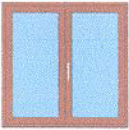
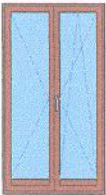
TYPES ACHIEVABLE

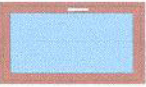
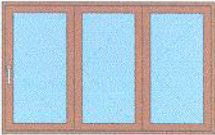
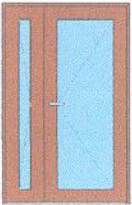
				
Window 1 or more wings	French window 1 or more wings	Fixed glazing panelling	Parallel sliding windows	Wasistas
				
Folding windows	Entrance doors			

* Calculation done according to UNI EN ISO 10077 -1 on a window 1230 X 1480 with a glass $U_g=1,0 \text{ W/m}^2\text{K}$