

SK65 Series Data sheet

The SK65 open-joint product is characterised by its round design and by an aluminium snap-lock glazing bead that guarantees the insulation of the internal wood from external pressures: this makes the installation and the maintenance of the windows easier. Thanks to the appropriate anti-intrusion hardware kit, a high level of protection against burglary attempts is guaranteed; in fact it has obtained the UNI ENV 1627 (anti-intrusion) class 2 certification awarded by the Giordano Institute.

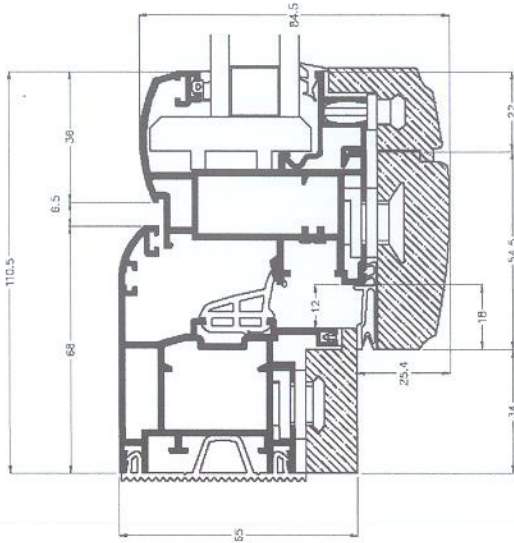

Technical characteristics:

System to open-joint
 Glass application: with an aluminium snap-lock glazing bead covered by a wooden snap-lock frame.
 Aluminium alloy: 6060 (UNI 3569).
 Wood types: oak, ash, cherry, maple
 Frame thickness 65 mm
 Wing thickness 84.5 mm

Thermal performance*:

one-wing window:

Uw 2,0 W/m²K

two-wings window:

Uw 2,3 W/m²K

Test:

Air (UNI EN 1026)

4

Water (UNI EN 1027)

9A

Wind (UNI EN 12211)

C5



Thermal (UNI EN 1077-2)

Uf 3,8 W/m²K

Resistance to intrusion
(UNI ENV 1627)

CLASS 2

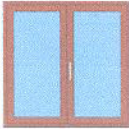
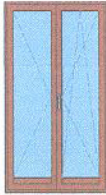
TYPES ACHIEVABLE

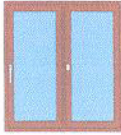
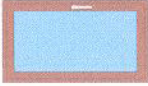
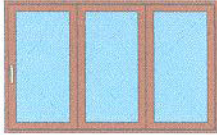
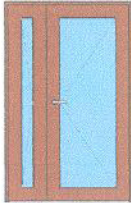
				
Window 1 or more wings	French window 1 or more wings	Fixed glazing panelling	Parallel sliding windows	Wasistas
				
Folding windows	Entrance doors			

* Calculation done according to UNI EN ISO 10077 -1 on a window 1230 X 1480 with a glass Ug=1,0 W/m²K