

## SW130s Series Data sheet

The SW130s in-line sliding window is the ideal solution for the creation of large glass-panelled surfaces, thanks to its load of 150 Kg per wing, capable of enhancing at best the architectural style of your own home.

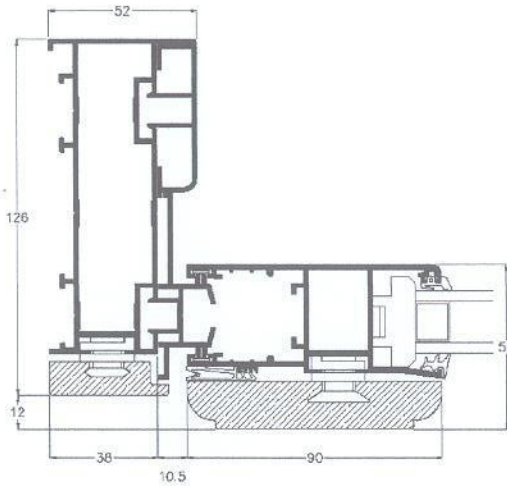

### Technical characteristics:

Glass application: slide-in system for aluminium wing

Aluminium alloy: 6060 (UNI 3569).

Wood types: oak, ash, cherry, maple

Frame thickness 126 mm

Wing thickness 58 mm

### Thermal performance\*:

*slide two wings*  $U_w 2,5 \text{ W/m}^2\text{K}$

### Test:

Thermal (UNI EN 1077-2)  $U_f 4,47 \text{ W/m}^2\text{K}$

### TYPES ACHIEVABLE

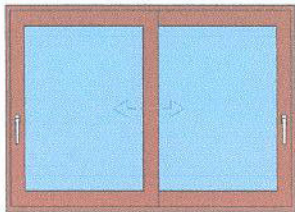

Slide 2 wings on two rails

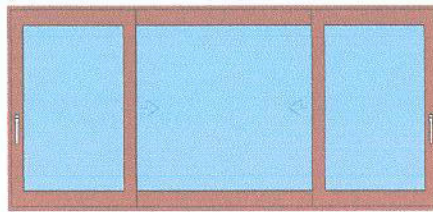

Slide 3 wings on two rails

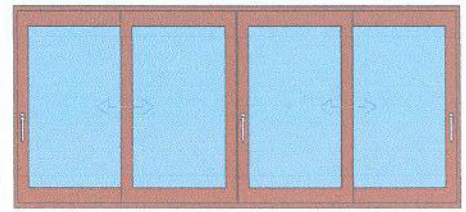

Slide 4 wings on two rails

\* Calculation done according to UNI EN ISO 10077 -1 on a window 1230 X 1480 with a glass  $U_g 1,6 \text{ W/m}^2\text{K}$